

- Rugged brass body design
- Standard or high temperature options
- Low 0,1 bar operating pressure
- Full flow in one direction only
- Compact design

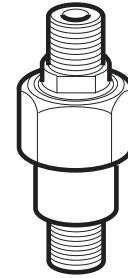

## Operating information

Operating pressure:	0,1 to 17 bar
Flow:	Qmax at 6 bar, l/min* 1/8 = 1200L/m; 1/4 - 1350 L/m
Operating temperature:	Standard: -26°C to +85°C High: -26°C to +230°C
Body material:	Brass
Seal material:	Standard: Nitrile High: Viton

## Standard version

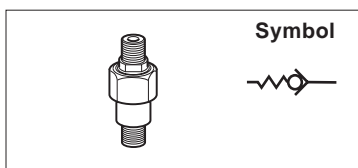

Thread size	Weight kg	Order code
G1/8	0,68	<b>3047X</b>
G1/4	0,72	<b>3047B</b>

## High temperature version

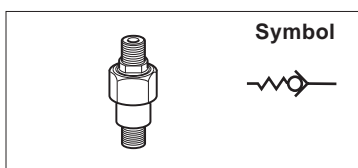

Thread size	Weight kg	Order code
G1/8	0,68	<b>3047XV</b>
G1/4	0,72	<b>3047BV</b>

## Dimensions

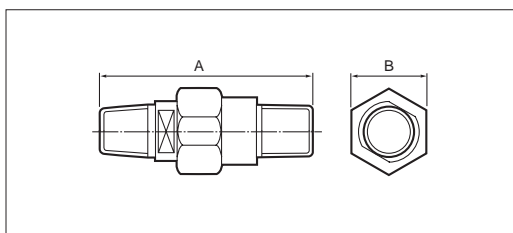

Order code	Port Size	A	B
<b>3047X/XV</b>	G1/8	51	21
<b>3047B/BV</b>	G1/4	49	21

- Aluminium bodies
- Long life
- Low opening pressure
- Full flow in one direction only

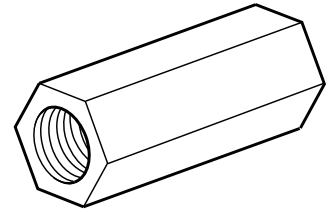

## Operating information

Operating pressure: 0,1 to 10 bar  
 Operating temperature: -20°C to +70°C  
 Body material: Anodised aluminium  
 Seal material: Nitrile

## VB - Aluminium

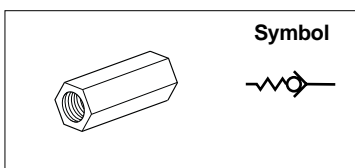

Port size	Opening pressure bar	Weight kg	Order code
G1/8	0,25	0,01	<b>VB12-Q-NQ-5</b>
G1/4	0,10	0,01	<b>VB22-Q-NQ-5</b>
G1/2	0,10	0,05	<b>VB42-Q-NQ-5</b>

## Dimensions

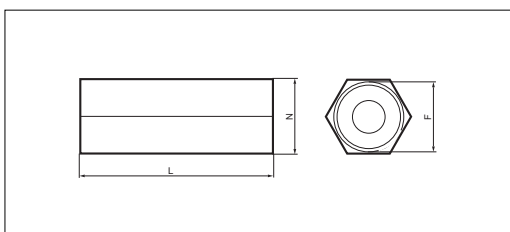

Order code	F	L	N
<b>VB12-Q-NQ-5</b>	G1/8	31	14
<b>VQB22-Q-NQ-5</b>	G1/4	40	17
<b>VB42-Q-NQ-5</b>	G1/2	59	27

- Low 0,1 bar operating pressure
- Full flow in one direction only
- Compact design
- Instant push-in connections

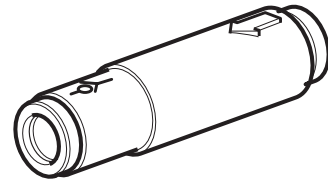

## Operating information

Operating pressure:	0,2 to 10 bar
Flow:	See below
Operating temperature:	-15°C to +70°C
Storage temperature:	-20°C to +70°C
Body material:	Thermo plastic

## Line Mounted Non-return Valves

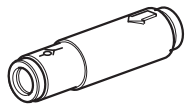

Symbol



Sold in lots of 10

Push-in Connection Ømm	Flow Rate at 6 bar, l/s	Weight	Order code Kg
4	200	0,01	<b>PWA-L1444</b>
6	660	0,02	<b>PWA-L1446</b>
8	1600	0,02	<b>PWA-L1448</b>

## Dimensions

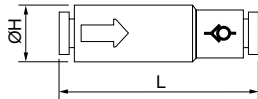

Order code	ØH	L
<b>PWA-L1444</b>	11,0	43,0
<b>PWA-L1466</b>	13,0	49,5
<b>PWA-L1488</b>	13,5	55,0

# Service and Replacement Parts

---

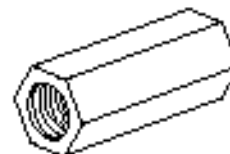
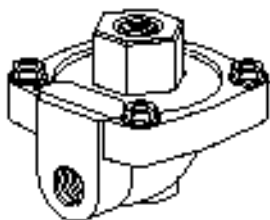
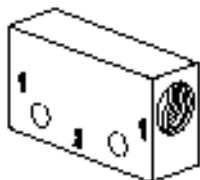

## P4Q Series Quick Exhaust Valves

Part Number	Repair Kit	
	Standard (* = A)	High Temperature (* = V)
P4Q-B*12	3340BR	3340BVR
P4Q-B*13		
P4Q-C*14	3340CR	3340CRV
P4Q-C*16		

## Shuttle Valves

No internal components available, **replace complete valve.**

## PWA-L Line Mounted Non-return Valves

No internal components available, **replace complete valve.**

## VB Series Non-return Valves

Part Number	Valve Seat
VB12-Q-NQ-5	9124863400
VB22-Q-NQ-5	9124864100
VB42-Q-NQ-5	9124864800